

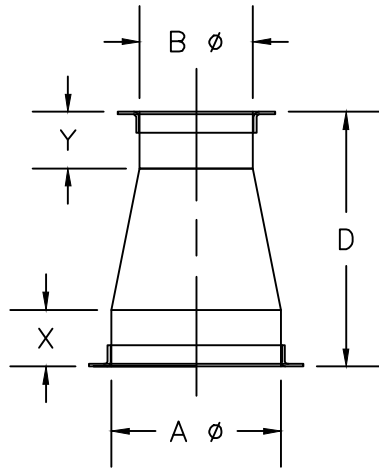

**Kem-Tuff™**  
CORROSIVE AIR TRANSFER SYSTEMS

NOTE\* When ordering, refer to RET STANDARDS sheet



# Reducer Concentric - RET

CONNECTIONS\* REFER TO LEGEND

FITTING #	A $\phi$	B $\phi$	D	X	Y	STANDARD*		USE FOR NON-STANDARD FLANGES ONLY						REMARKS	
						"A"	"B"	SPEC	I.D.	O.D.	B.C.	HOLE SIZE	# OF HOLES		
								"A"							
								"B"							
								"A"							
								"B"							
								"A"							
								"B"							
								"A"							
								"B"							

Pressure Class in w.g.    +    -    1    2    3    4    5    6    7    8    9    10    11    12    13    14    15    16

Company Name: \_\_\_\_\_  
 Contact Name: \_\_\_\_\_ Phone#: \_\_\_\_\_  
 Project Name: \_\_\_\_\_ Date: \_\_\_\_\_  
 Project #: \_\_\_\_\_ GDS Project #: \_\_\_\_\_

**\*CONNECTION LEGEND\***

TYPE	MATERIAL
KF = NW-ISO-KF	BI = BLACK IRON
FB = FLAT BAR	304 = STAINLESS
AR = ANGLE RING	SPEC = FB 304 S.S. ONLY
RAW = NO FLANGE	

SPECIFY UNDER "CONNECTIONS" STD COLUMN: FLANGE TYPE AND MATERIAL, IF OTHER THAN STD 304 S.S.