

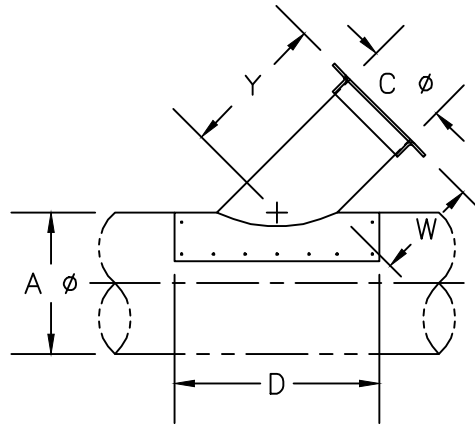

NOTE* When ordering, refer to LAT TP STANDARDS sheet



Lateral Tap

- LAT TP

CONNECTIONS*		REFER TO LEGEND				
STANDARD*	USE FOR NON-STANDARD FLANGES ONLY					

FITTING #	A ϕ	C ϕ	D	W	Y	CONNECTIONS*						REMARKS	
						"C"	SPEC	I.D.	O.D.	B.C.	HOLE SIZE		# OF HOLES
						"C"	SPEC	I.D.	O.D.	B.C.	HOLE SIZE	# OF HOLES	
							X						
						"C"	SPEC	I.D.	O.D.	B.C.	HOLE SIZE	# OF HOLES	
							X						
						"C"	SPEC	I.D.	O.D.	B.C.	HOLE SIZE	# OF HOLES	
							X						
						"C"	SPEC	I.D.	O.D.	B.C.	HOLE SIZE	# OF HOLES	
							X						

Pressure Class in w.g.	+	-	1	2	3	4	5	6	7	8	9	10	11	12	13	14	15	16
------------------------	---	---	---	---	---	---	---	---	---	---	---	----	----	----	----	----	----	----

Company Name: _____
 Contact Name: _____ Phone#: _____
 Project Name: _____ Date: _____
 Project #: _____ GDS Project #: _____

CONNECTION LEGEND	
TYPE	MATERIAL
KF = NW-ISO-KF	BI = BLACK IRON
FB = FLAT BAR	304 = STAINLESS
AR = ANGLE RING	SPEC = FB 304 S.S. ONLY
RAW = NO FLANGE	

STANDARD ELBOWS SHALL HAVE A MINIMUM CENTELINE RADIUS 1-1/2 TIMES THE DUCT DIAMETER WHENEVER POSSIBLE. HALF-RADIUS ELBOWS AVAILABLE UPON REQUEST.