

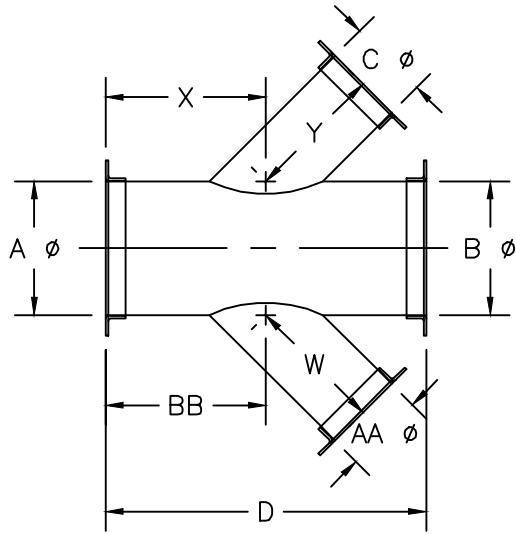

NOTE* When ordering, refer to LATC45 STANDARDS sheet



Lateral Cross

- LATC 45

FITTING #	A ø	B ø	AA ø	BB	C ø	D	W	X	Y	CONNECTIONS* REFER TO LEGEND				SPEC	I.D.	O.D.	B.C.	HOLE SIZE	# OF HOLES	REMARKS
										"A"	"B"	"AA"	"C"							
													"A"							
													"B"							
													"AA"							
													"C"							
													"A"							
													"B"							
													"AA"							
													"C"							

Pressure Class in w.g. + - 1 2 3 4 5 6 7 8 9 10 11 12 13 14 15 16

Company Name: _____
 Contact Name: _____ Phone#: _____
 Project Name: _____ Date: _____
 Project #: _____ GDS Project #: _____

CONNECTION LEGEND	
TYPE	MATERIAL
KF = NW-ISO-KF	BI = BLACK IRON
FB = FLAT BAR	304 = STAINLESS
AR = ANGLE RING	SPEC = FB 304 S.S. ONLY
RAW = NO FLANGE	

STANDARD ELBOWS SHALL HAVE A MINIMUM CENTELINE RADIUS 1-1/2 TIMES THE DUCT DIAMETER WHENEVER POSSIBLE. HALF-RADIUS ELBOWS AVAILABLE UPON REQUEST.