

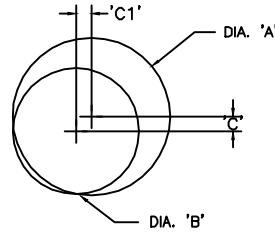

NOTE* When ordering, refer to ERFF STANDARDS sheet

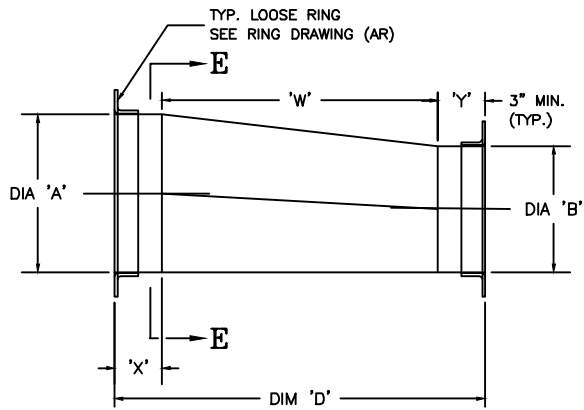

Eccentric Reducer - ERFF

CONNECTIONS* REFER TO LEGEND

STANDARD*		USE FOR NON-STANDARD FLANGES ONLY							
"A"	"B"	SPEC	I.D.	O.D.	B.C.	HOLE SIZE	# OF HOLES	REMARKS	
		"A"							
		"B"							
		"A"							
		"B"							
		"A"							
		"B"							
		"A"							
		"B"							

FITTING #	A ϕ	B ϕ	C	C1	D	W	X	Y	DR	"A"	"B"	SPEC	I.D.	O.D.	B.C.	HOLE SIZE	# OF HOLES	REMARKS	
												"A"							
												"B"							
												"A"							
												"B"							
												"A"							
												"B"							
												"A"							
												"B"							

Pressure Class in w.g. + - 1 2 3 4 5 6 7 8 9 10 11 12 13 14 15 16

Company Name: _____
 Contact Name: _____ Phone#: _____
 Project Name: _____ Date: _____
 Project #: _____ GDS Project #: _____

CONNECTION LEGEND	
TYPE	MATERIAL
KF = NW-ISO-KF	BI = BLACK IRON
FB = FLAT BAR	304 = STAINLESS
AR = ANGLE RING	SPEC = FB 304 S.S. ONLY
RAW = NO FLANGE	

SPECIFY UNDER "CONNECTIONS" STD COLUMN: FLANGE TYPE AND MATERIAL, IF OTHER THAN STD 304 S.S.