

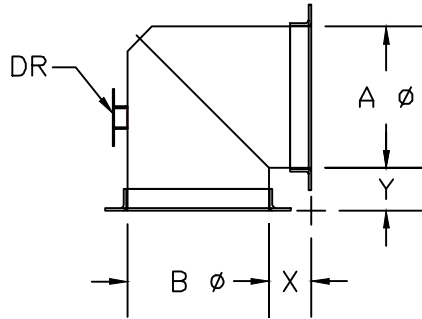

**Kem-Tuff™**  
CORROSIVE AIR TRANSFER SYSTEMS

NOTE\* When ordering, refer to EL60  
2 Gore STANDARDS sheet



# 90° Elbow - 2 Gore

EL90

CONNECTIONS\* REFER TO LEGEND

FITTING #	A ø	B ø	C	X	Y	STANDARD*		USE FOR NON-STANDARD FLANGES ONLY						
						"A"	"B"	SPEC	I.D.	O.D.	B.C.	HOLE SIZE	# OF HOLES	
								"A"						
								"B"						
								"A"						
								"B"						
								"A"						
								"B"						
								"A"						
								"B"						

Pressure Class in w.g.    +    -    1    2    3    4    5    6    7    8    9    10    11    12    13    14    15    16

Company Name: \_\_\_\_\_  
 Contact Name: \_\_\_\_\_ Phone#: \_\_\_\_\_  
 Project Name: \_\_\_\_\_ Date: \_\_\_\_\_  
 Project #: \_\_\_\_\_ GDS Project #: \_\_\_\_\_

\*CONNECTION LEGEND\*

TYPE	MATERIAL
KF = NW-ISO-KF	BI = BLACK IRON
FB = FLAT BAR	304 = STAINLESS
AR = ANGLE RING	SPEC = FB 304 S.S. ONLY
RAW = NO FLANGE	

STANDARD ELBOWS SHALL HAVE A MINIMUM CENTELINE RADIUS 1-1/2 TIMES THE DUCT DIAMETER WHENEVER POSSIBLE.  
 HALF-RADIUS ELBOWS AVAILABLE UPON REQUEST.