

Kem-Tuff™
CORROSIVE AIR TRANSFER SYSTEMS

45° Takeoff - BTO

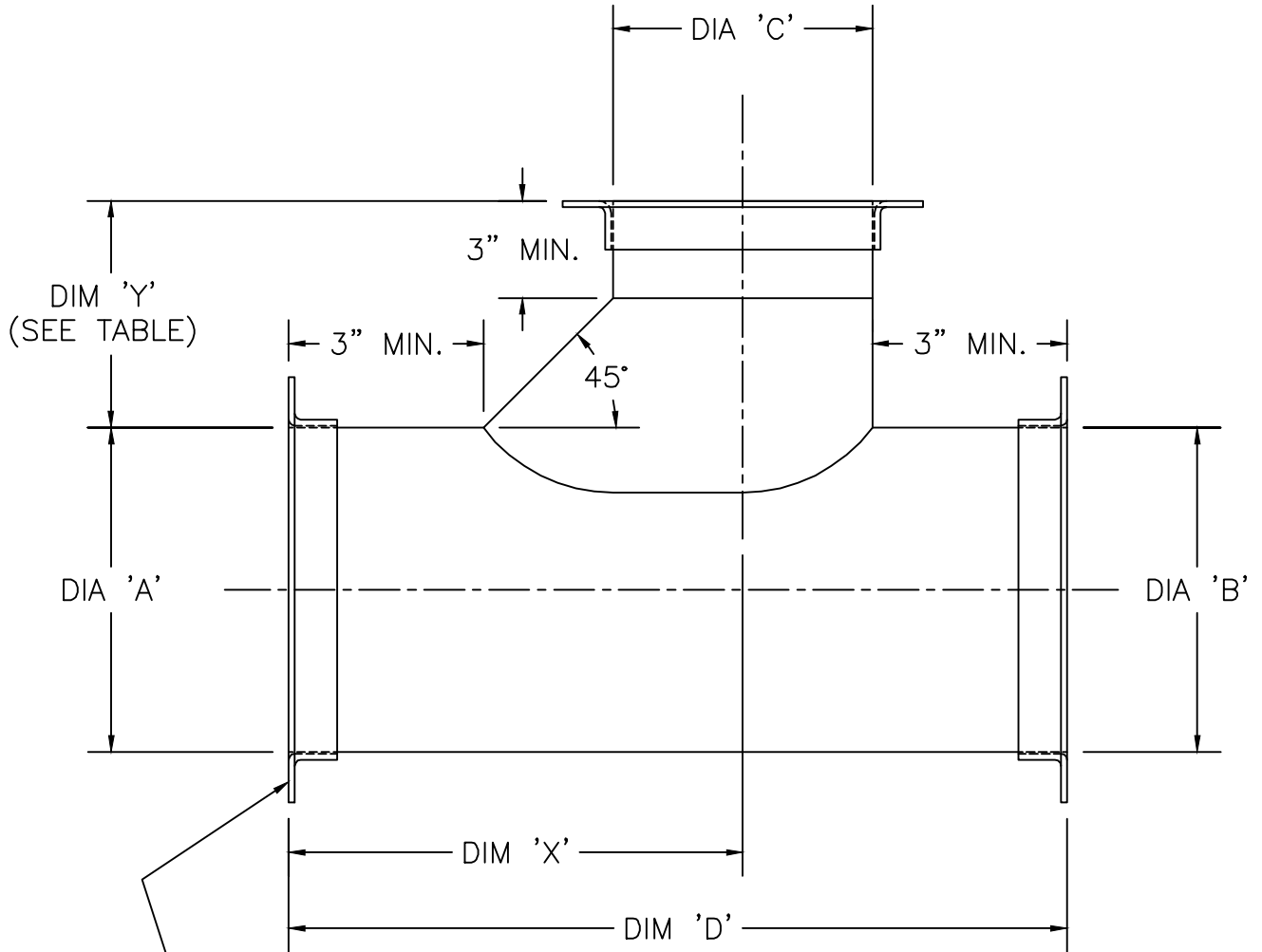

TYP. LOOSE RING
SEE RING DRAWING (AR)

TABLE	
DIA "A "	DIM "Y "
5 - 16" ϕ	7" MIN
17 - 24" ϕ	9" MIN
25" ϕ +	12" MIN